

Adjustable Type Coils K Type Series

Coils, Filters

K5-S

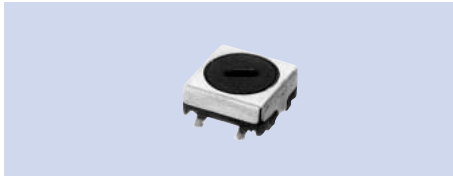

Specifications

- (1) 1~300μH (4) -
- (2) 0.1~20MHz (5) 40~70
- (3) F:±2%
- L:±4%

Features

- SMD
- 1000pcs./Reel

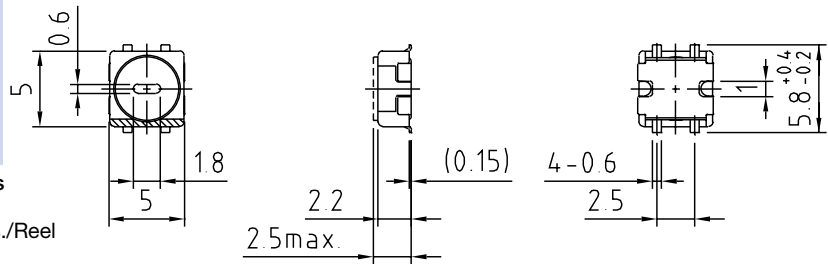

K5-S2



Specifications

- (1) 1~300μH
- (2) 0.1~20MHz
- (3) F:±2%
- L:±4%
- (4) -
- (5) 40~70

Features

- SMD
- 1000pcs./Reel

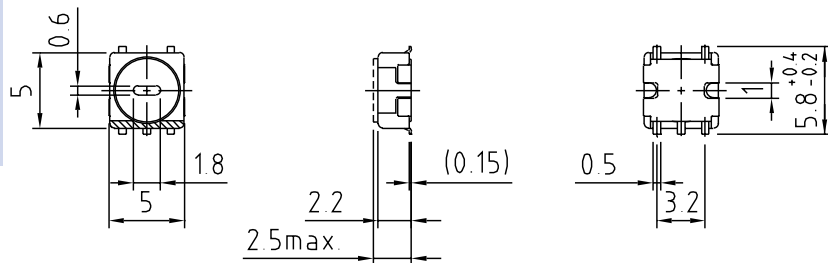

K5-N1



Specifications

- (1) 1~1200μH
- (2) 0.1~20MHz
- (3) F:±2%
- L:±5%
- (4) 5~15000pF×2
- (5) 50~80

Features

- SMD
- 1000pcs./Reel

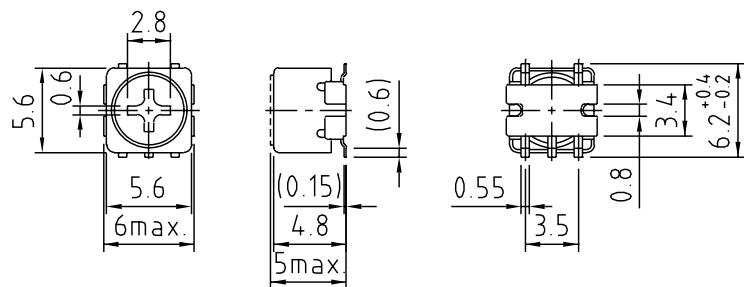

K5-N



Specifications

- (1) 1~5900μH
- (2) 0.1~20MHz
- (3) F:±2%
- L:±5%
- (4) 5~15000pF×2
- (5) 50~100

Features

- SMD
- 1000pcs./Reel

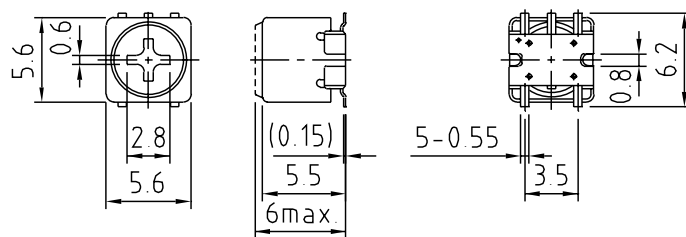

- (1) Inductance
- (2) Operational frequency
- (3) Variable range of F & L
- (4) Internal capacitance
- (5) Unloaded Q

K5-R2

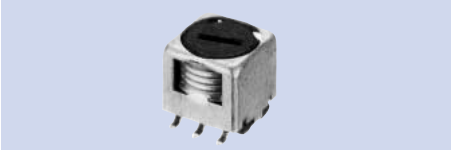

Specifications

- | | | |
|---------------|---------------|---|
| (1) 1~6700μH | (4) 5~15000pF | 2 |
| (2) 10~500kHz | (5) 50~80 | x |
| (3) F:±2% | | |
| L:±4% | | |

Features

SMD
500psc./Reel

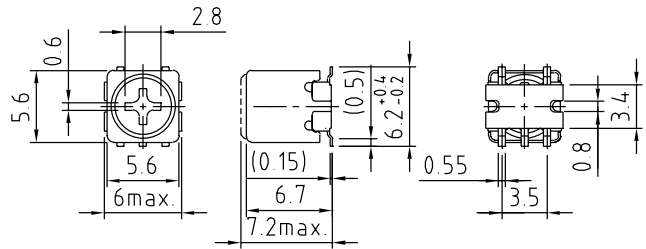

K5-H



Specifications

- | | |
|---------------|----------------|
| (1) 1~1000μH | (4) 10~10000pF |
| (2) 0.1~20MHz | (5) 50~100 |
| (3) F:±2% | |
| L:±5% | |

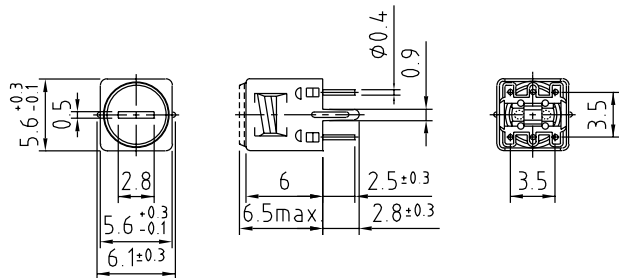

K5-C



Specifications

- | | |
|---------------|----------------|
| (1) 1~1000μH | (4) 10~10000pF |
| (2) 0.1~20MHz | (5) 50~100 |
| (3) F:±2% | |
| L:±5% | |

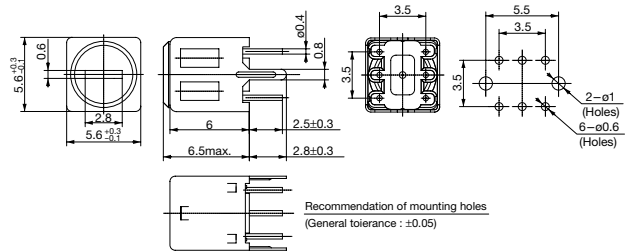

K7-P

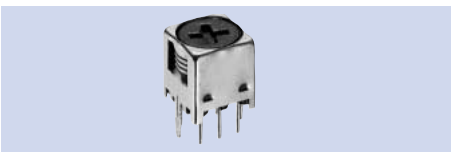

Specifications

- | | |
|---------------|----------------|
| (1) 1~1600μH | (4) 10~18000pF |
| (2) 0.1~20MHz | (5) 50~110 |
| (3) F:±2% | |
| L:±5% | |

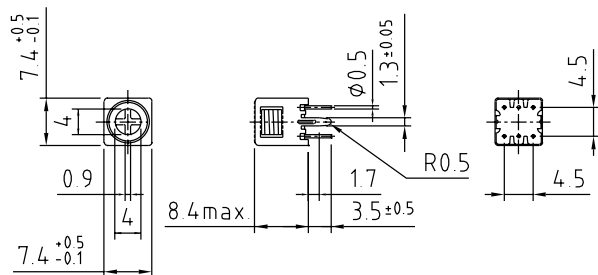

K7-P1

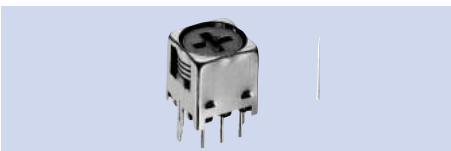

Specifications

- | | |
|---------------|-----------|
| (1) 0.1~7mH | (4) - |
| (2) 10~300kHz | (5) 40~70 |
| (3) F:±2% | |
| L:±5% | |

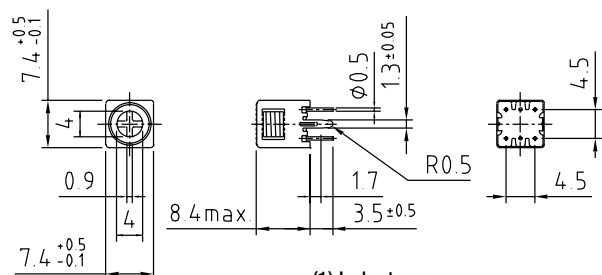

- (1) Inductance
- (2) Operational frequency
- (3) Variable range of F & L
- (4) Internal capacitance
- (5) Unloaded Q

K7-D

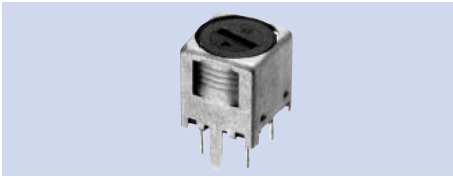

Specifications

- (1) 5~100mH
- (2) 10~300kHz
- (3) F:±2%
L:±5%
- (4) -
- (5) 50~80

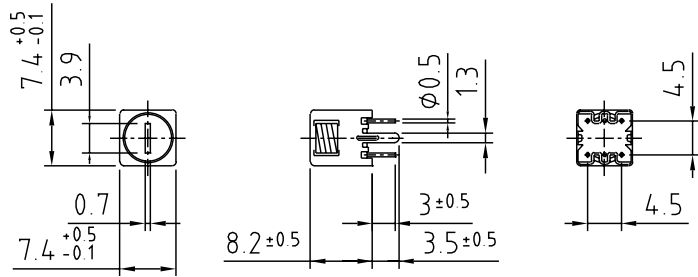

K7-T



Specifications

- (1) 1~850μH
- (2) 0.1~20MHz
- (3) F:±2%
L:±5%
- (4) 10~430pF
- (5) 60~110

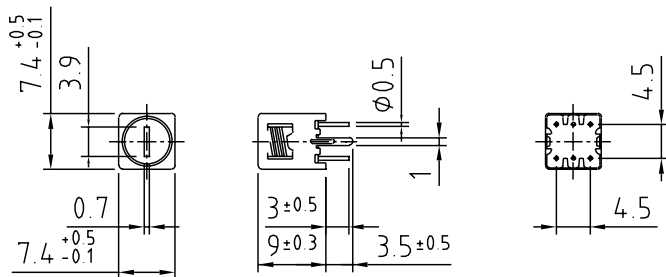

K7-T1

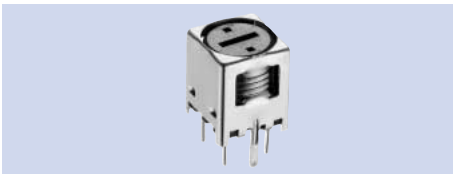

Specifications

- (1) 0.1~6mH
- (2) 10~300kHz
- (3) F:±2%
L:±5%
- (4) -
- (5) 40~70

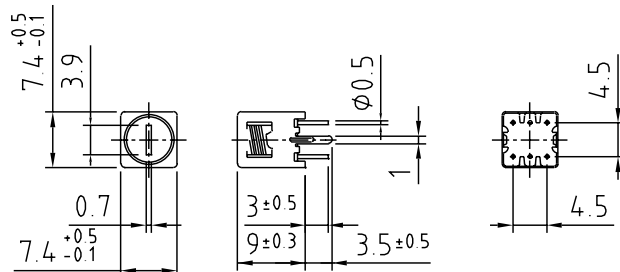

K7-T4

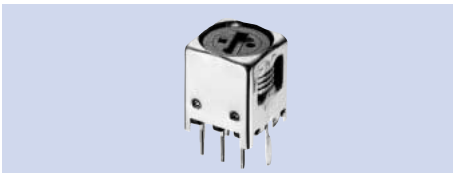

Specifications

- (1) 1~15mH
- (2) 10~300kHz
- (3) F:±2%
L:±5%
- (4) 10~18000pF
- (5) 40~70

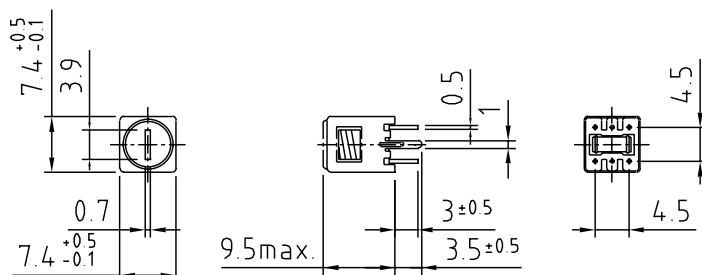

- (1) Inductance
- (2) Operational frequency
- (3) Variable range of F & L
- (4) Internal capacitance
- (5) Unloaded Q

K7-T3

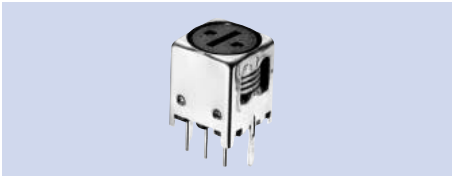

- Specifications
 (1) 1~40mH
 (2) 0.1~1MHz
 (3) F:±2%
 L:±5%
 (4) -
 (5) 50~140

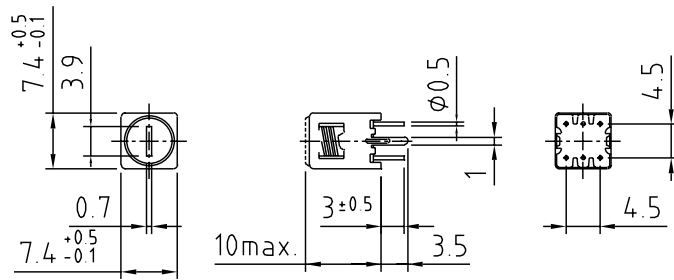

K7-H5(K7-H6)



- Specifications
 (1) 1~1000μH
 (2) 0.1~20MHz
 (3) F:±3%
 L:±6%
 (4) 10~18000pF
 (5) 50~140

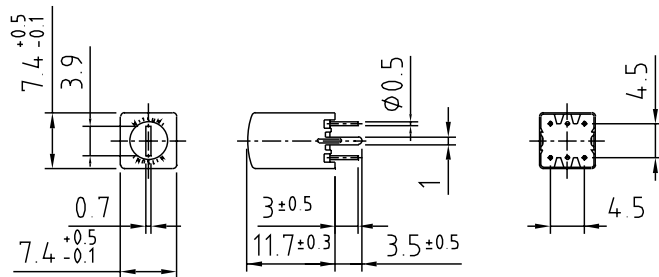

K7-J



- Specifications
 (1) 1~40mH
 (2) 10~300kHz
 (3) L:±6%
 (4) -
 (5) 40~70

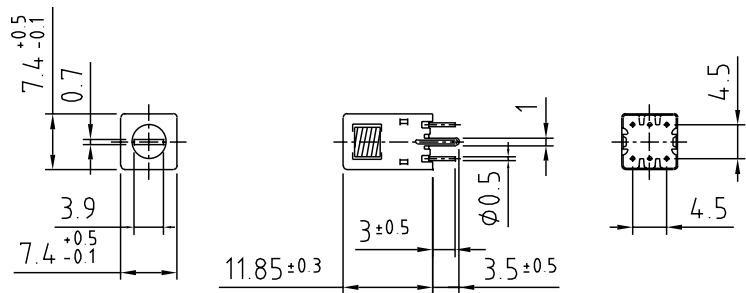

K7-J5



- Specifications
 (1) 1~40mH
 (2) 10~300kHz
 (3) F:±3%
 L:±6%
 (4) 10~18000pF
 (5) 40~70

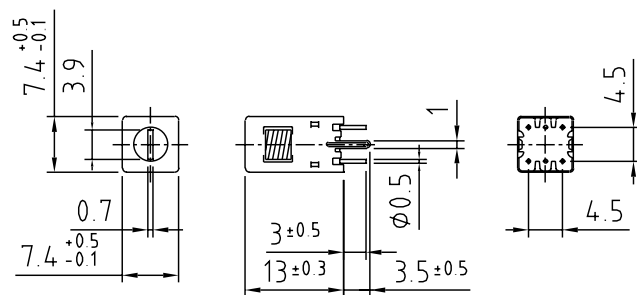

- (1) Inductance
 (2) Operational frequency
 (3) Variable range of F & L
 (4) Internal capacitance
 (5) Unloaded Q